

For Advice. For Help. For Repairs:

+44 (0) 1296 390 390
seriousreaders.com



The Chapel of Light, Aylesbury Road, Bierton, Bucks, HP22 5DW, Great Britain

Classic

Instructions

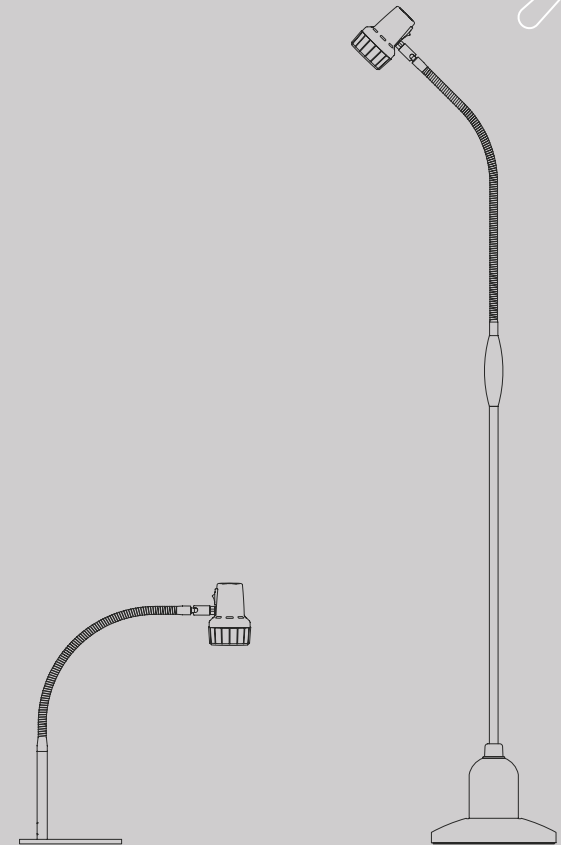

Keep for reference



Classic Light

Getting Started

Your light is ready to plug in and use. The standby switch is located on the head of the light. If the switch has 0/1 markings, the light is not dimmable. A blank switch indicates the light is dimmable.

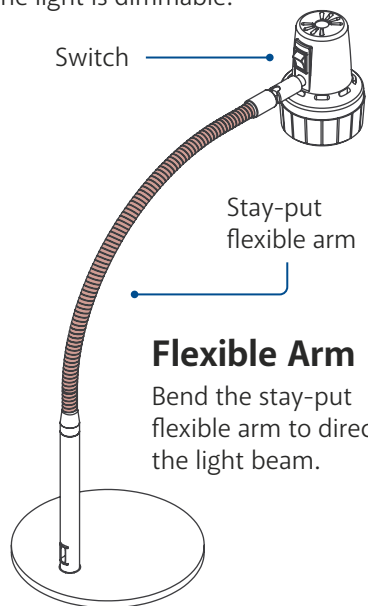

Model Shown:
Lightweight Table.

Swivel Joint

For fine positioning of the light beam.

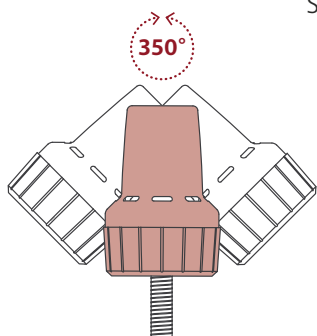

Changing the Bulb

Disconnect from power and allow to cool. Unscrew the ribbed front shade by rotating it anti-clockwise.

Pull out the old two pinned bulb. **Do not twist it.** Insert the new bulb. Screw the shade clockwise back onto the lamp head.

Safety

Cord replacement Type X. Please contact us if there is any cable damage. Do not attempt a repair. **Indoor use only.**

Standby Mode

It is normal to leave the light on standby when not in use.

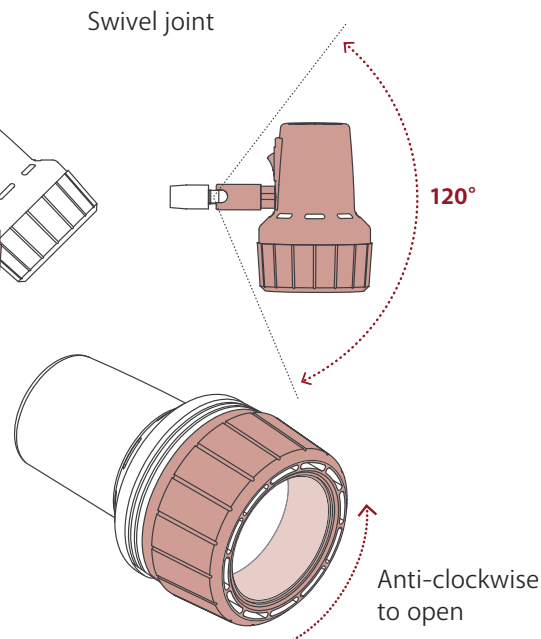
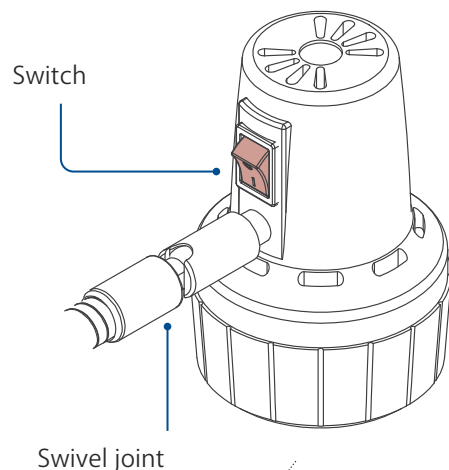

Classic Light

Changing the Driver and Plug

The plug-in driver is detachable. The plug-type is also interchangeable to fit international sockets. To remove the plug-type, slide the button downwards, push the three pin plug attachment upwards to release. Click the alternative into place.

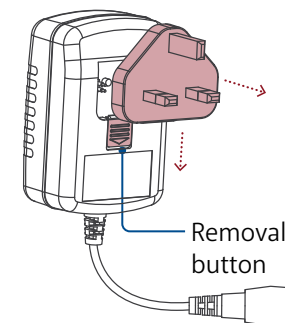

Non-Standard Models (specified at purchase)

These options are not fitted as standard. They need to be specified and paid for when a light is ordered. They cannot be retrofitted.

Height-Adjustable

Turn the locking wheel anti-clockwise to unlock the arm and tighten clockwise to lock it in position.

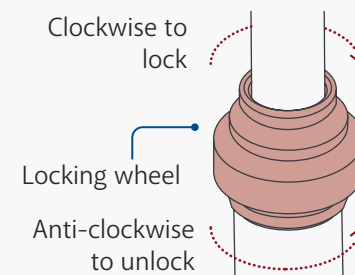

Dimmer

Turn the light ON by using a quick, firm click of the switch. To engage the dimmer, hold the switch down and the light will dim down and back up again. Release the switch at the desired light level. Use a quick, firm click to turn the light off.

Using the standby switch, the light will return to the same brightness level. Turning off at the mains will erase the memory and return the light to the brightest setting.

Cordless

When fully charged the light will give up to 7.5 hours of use. There is no loss of light as the battery drains. Recharge using the cordless charging plug. The charging point is on the light base. While charging, a red light is visible. Once charged this turns green. A full recharge takes approximately 2 hours. The light is delivered partially charged.

